



the Gate art space

21 Westgate Street, Gloucester



Impression after rebranding of fascia

The Gate art space in the city centre is available to hire. Currently branded under its old name 'Cathedral Quarter', the fascia will soon be painted with the new name.

Situated at 21 Westgate Street, **The Gate** has a double-fronted shop window, 32 sq mtr of floor space and a ceiling height of at least 2.74m. The stepped floor inside is accessible using a ramp. The space has a sink with hot and cold water and there is unisex sanitary accommodation with washhand basin and W.C. to the rear.

The interior has been restored with an interesting mix of plaster wall and exposed timbers contrasting with industrial chic galvanised wiring conduits, a contemporary lighting system and copious sockets.

The Gate is situated in the heritage Fleece Inn building. Whilst the owners (Gloucester City Council) cannot allow direct fixing to the walls and ceiling of the front half of this heritage space, there is a hanging system throughout to enable the display of 2d work on the walls.

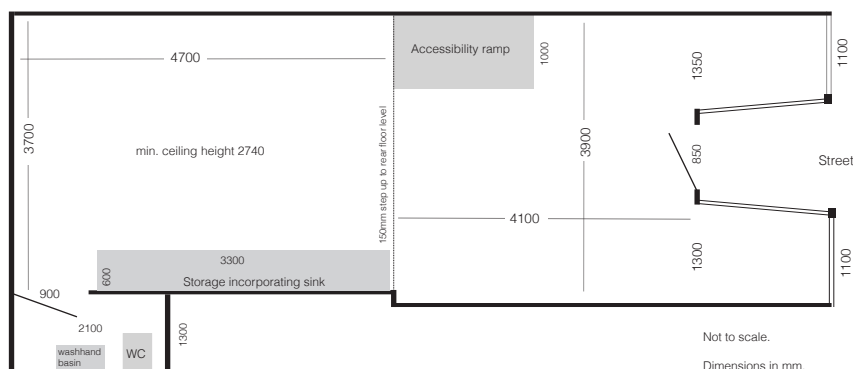

The space is adaptable for many art uses. In addition to its potential for an excellent gallery, it could also be used as a project space for residencies and workshops.

Westgate Street is a popular area of the city centre with high footfall and No 21, being close to the Cathedral and situated opposite the Gloucester Antique Centre, is well placed to take advantage of passing tourists and locals.

The hiring fee is £200 (£100 for GCA members) April to September; or £250 (£150 for GCA members) October to March.